

ACKIT1B

Products Included:

- (1) A2E4
- (1) A2M
- (4) AP300HA
- (1) APSC1 (pack of 25)
- (1) AP4 (License)

A2E4

2 door controller - expandable up to 4 doors, basic power

Features

- Embedded Linux operating system
- Expandable up to 4 doors (when used with A2M board)
- 2 Readers (In/Out)
- 2 Relays (Lock/Aux)
- 3 Inputs (REX, DPS, Aux) Global
- UL listed - 294 Series 7
- 5 year warranty
- NDAA Compliant*

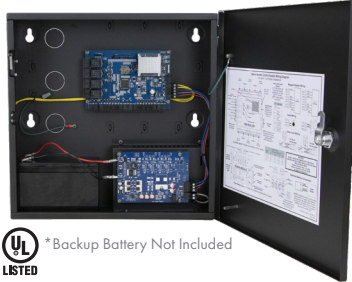

*Backup Battery Not Included

Technical Specification

Processor	Quad Core Cortex, 1.5 GHz
Memory	1GB DDR3 & 8GB eMMC
Operating System	Embedded Linux
Transactions	> 45 per second
System Power Requirements	115VAC @ 1.5A
Operating Temperature	50°F to 95°F (10°C to 35°C)
Enclosure Size (W x H x D)	14.25 x 14.25 x 3.75in (362 x 362 x 95mm)
Internal Power Supply	Controller & Readers Only
Lock Power Output	NA
Battery Backup	Controllers & Readers Only
Recommended Battery Type (battery is not included)	Powersonic PS-1270-FI or Similar 12V, 7AH, Sealed Lead Acid with 0.187 inch terminals
Standby Power Requirement	400mA @ 12V
Readers (Wiegand)	4 Total, One In & One Out Reader for Each Door
Reader Power	300mA @ 12V Max per Reader, 1000mA @ 12V Max per System
Request to Exit (REX) Inputs	2 Total, One for Each Door
Door Position (status) Inputs	2 Total, One for Each Door
Auxiliary Input	2 Total, General Purpose
Tamper Digital Input	Yes, Prewired on Units with Integrated Power
Power Fault Digital Input	Yes, Prewired on Units with Integrated Power
Door Lock Outputs	2 Form C Relay, 24V @ 2.0A
Auxiliary Outputs	2 Form C Relay, 24V @ 2.0A

A2M

Add on 2 door module to use with A2E4 and A2E4P



Features

- Expands A2E4/A2E4P up to 4 doors
- 2 Readers (In/Out)
- 2 Relays (Lock/Aux)
- 3 Inputs (REX, DPS, Aux) Global
- UL listed - 294 Series 7
- 5 year warranty
- NDAA Compliant*

Technical Specification

Operating Temperature	50°F to 95°F (10°C to 35°C)
Dimensions	6.125 x 4.25 x 0.75in
Internal Power Supply	Controller & Readers Only
Readers (Wiegand)	4 Total, One In & One Out Reader for Each Door
Reader Power	300mA @ 12V Max per Reader 1000mA @ 12V Max per System
Request to Exit (REX) Inputs	2 Total, One for Each Door
Door Position (status) Inputs	2 Total, One for Each Door
Auxiliary Input	2 Total, General Purpose
Door Lock Outputs	2 Form C Relay, 24V @ 2.0A
Auxiliary Outputs	2 Form C Relay, 24V @ 2.0A

AP300HA

Mullion proximity reader



Features

- Up to 5 in of read range
- Contactless Digital Radio Frequency Identification (RFID) technology
- Compliant with the Wiegand communication protocol
- IP67 compliant, weather resistant
- Tamper resistant
- UL Listed
- Lifetime warranty
- NDAA Compliant*



Technical Specification

Technology	Proximity
Frequency	125 kHz
Mounting	Mullions, including metal door and window frames, as well as flat surfaces
Dimensions	1.7" W x 3.2" H x 0.7" D (43 mm x 81 mm x 18 mm)
Weight	3oz (85g)
Certifications	FCC, ICC, CE, C-Tick, UL Standard 294
IP Code	IP67
Voltage	+5 -16 VDC
Current Draw	30mA typical @ 12VDC, 195mA peak
Read Range	Up to 5 inches (126 mm)
Cabling	24 AWG minimum, multiconductor stranded with an overall foil shield
Interface	Wiegand ABA Track II
Operating Temperature	-40°F to 149°F (-40°C to 65°C)
Color Options	Black and an ivory snap-on cover included standard
Audio Tone	Beeper included standard
Indoor & Outdoor Installation	Electronics sealed in weather- and tamper-resistant epoxy potting
Warranty	Lifetime warranty
LED	Four-state standard (red, green, amber, and off)
Technologies Supported	Pyramid + certain HID® 125-kHz Proximity protocols + certain AWID® 125-kHz Proximity protocols

Compatible Credentials



APSC1

Clamshell proximity card



Features

- Up to 8in contactless read range
- Contactless Digital Radio Frequency Identification (RFID) technology
- Frequency 125kHz
- Pack quantity: 25 cards
- Lifetime warranty
- NDAA Compliant*

Technical Specification

Technology	Proximity
Frequency	125 kHz
Operation	Passive (no battery)
Type	Clamshell card
Formats	Wiegand 26-bit
Material	ABS
Color	Off-White
Slot Punch	Standard, vertical slot
Marking	Date code and ID
Read Range	Up to 8in (202mm)
Warranty	Lifetime warranty
Dimensions	2.2" W x 3.4" H x 0.06" D (56mm x 86mm x 1.5mm)
Weight	0.3oz (9g)
Operating Temperature	-35°F to 122°F (-37°C to 50°C)
Humidity	0-95% non-condensing
Supporting Readers	AP300HA, AP500HA, AP620HA, AP640HA

NDAA COMPLIANT

*Products are in compliance with NDAA Section 889 Part B Guidelines